

DuraVane lubricated rotary vane pumps are single-stage pumps with an integrated closed loop oil recirculation system.

- Heavy duty construction.
- Compact design, small footprint.
- High-tech vane material provides long vane life.
- Gas ballast valve is standard.
- Low noise level.
- Low maintenance.
- Air-cooled design is standard.
- Internally mounted inlet check valve.
- High efficiency multi-stage exhaust filter removes 99.9% of exhaust smoke.
- Direct drive with flange mounted motor.
- Simple to install.

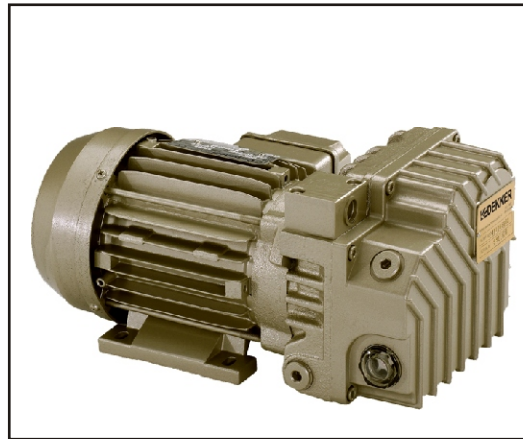

Performance characteristics

| | |
|----------------------|--|
| Displacement: | 8.5CFM |
| Final pressure: | 1.5Torr |
| Motor: | 0.75HP-50//60HzTEFC |
| Voltage: | 115/230V-1phase 208/230/460V-3phase |
| Speed: | 2900/3400RPM |
| Noise level(at 3ft): | 62dBA |
| Oil reservoir cap.: | 0.3qt |
| Oil type: | Duratex 32 |
| Weight: | 35Lbs |
| Inlet conn.: | 1/2"NPT |
| Discharge conn.: | - |

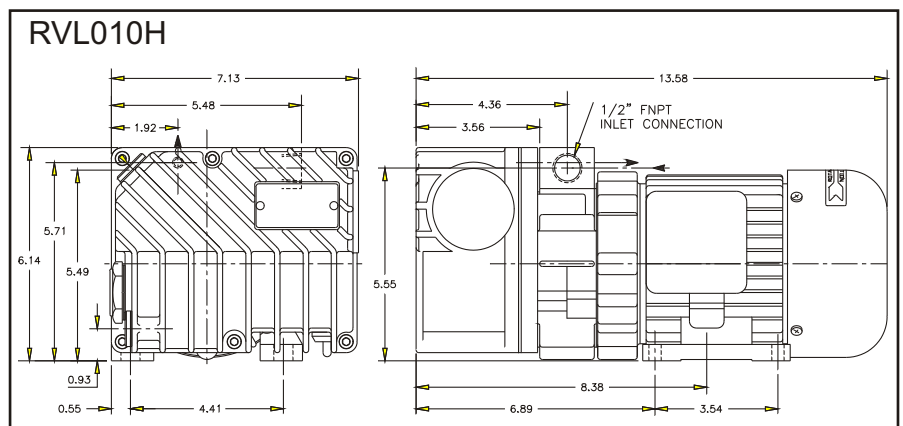
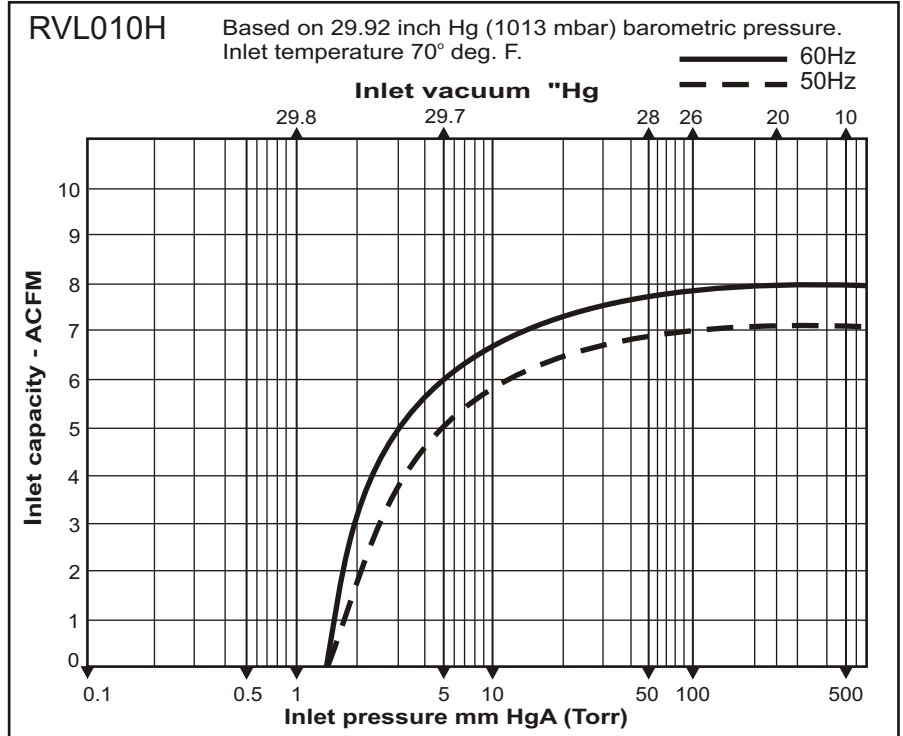

Information contained in this document is for reference only. Subject to change without notice.