

### DuraVane

Lubricated rotary vane pump  
RVL400HH/LH

**DuraVane** lubricated rotary vane pumps are single-stage pumps with an integrated closed loop oil recirculation system.

- Heavy duty construction.
- Compact design, small footprint.
- High-tech vane material provides long vane life.
- Low noise level.
- Low maintenance.
- Air-cooled design.
- Internally mounted inlet check valve and filter.
- High efficiency multi-stage exhaust filter removes 99.9% of exhaust smoke.
- Direct drive.
- Simple to install.

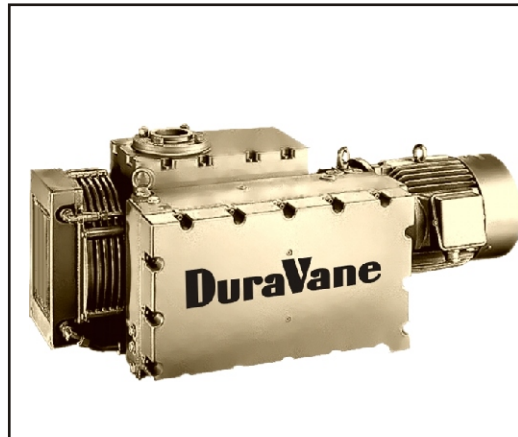

#### Performance characteristics

Displacement:	375CFM
Final pressure:	0.5/15Torr
Motor 50Hz:	15HP/11kW
Motor 60Hz:	20HP/15kW
Voltage:	230/380/460V/3phase
Speed 50Hz:	1450RPM
Speed 60Hz:	1800RPM
Noise level(at 3ft):	80dBA
Oil reservoir cap.:	11qt
Oil type:	Duratex 100
Weight:	790lbs
Inlet conn.:	3"NPT
Discharge conn.:	3"NPT

*For continuous operation from 300-0.5Torr select RVL400HH.  
For continuous operation from 500-15Torr select RVL400LH.*

RVL400HH/LH Based on 29.92 inch Hg (1013 mbar) barometric pressure.  
Inlet temperature 70° deg. F.

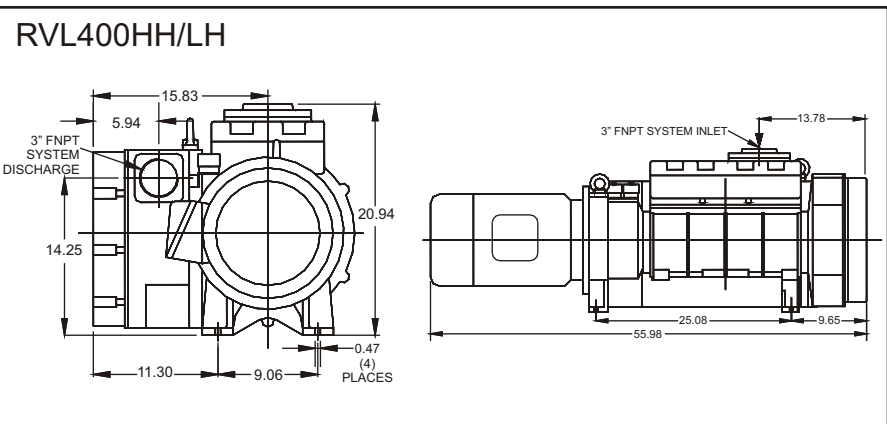
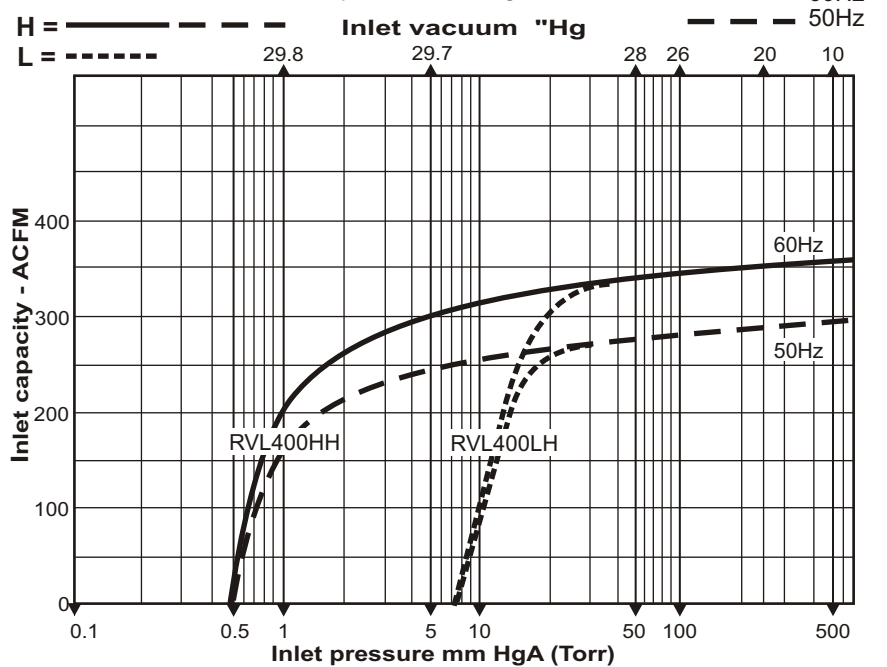

Information contained in this document is for reference only. Subject to change without notice.